

ELECTRIC FORKLIFT		SPECIFICATION VDI 2198				
Characteristics	1	Manufacturer	BALKANCAR RECORD			
	2	Type			ER 630.33.222 S ER 634.33.242 S	
	3	Load capacity	Q	kg	1250 1600	
	4	Load center	C	mm	500	
	5	Drive unit			Battery	
	6	Type of operation			Rider seated	
	7	Tyres			L/L (SE/SE)	
	8	Wheels (x-driven)			2 x / 2	
Dimensions	9	Lift	h_3	Lift height	mm	3300 ¹⁾
	10		h_2	Free lift	mm	90 ¹⁾
	11		h_5	Extended free lift	mm	- ¹⁾
	12	Fork carriage		According to DIN 15137, class/type		2 / A
	13	Fork dimensions	s/e/l	Thickness/width/length	mm	40 x 80 x 1150 ²⁾
	14	Tilt angle	α/β	Forward/backward	(°)	4°±1°/ 8°±1°
	15	Overall dimensions	L_2	Length	mm	1938
	16		B	Width	mm	995
	17		h_1	Height, mast lowered	mm	2220 ¹⁾
	18		h_4	Height, mast extended	mm	3825 ¹⁾
	19		h_6	Height of overhead guard	mm	2065
	20		h_7	Height of seat	mm	1050
	21	Turning radius	W_a	Outer turning radius	mm	1750
22	Load distance	X	Front axle center to fork face	mm	358	
23	Aisle width	Ast_4	For pallets 800x1200	mm	3450	
			For pallets 1000x1200	mm	3650	
Performance	24	Speed	Travel with load/without load	km/h	11 / 13	
	25		Lifting with load/without load	m/s	0,23 / 0,28	
	26		Lowering with load/without load	m/s	0,4 / 0,3	
	27	Rated drawbar pull		With load $S_2 - 60$ min	kN	1,7
	28	Maximum drawbar pull		With load $S_2 - 5$ min	kN	8,4
	29	Climbing ability		With load/without load $S_2 - 30$ min	%	4 / 8
30	Maximum climbing ability			With load/without load $S_2 - 1$ min	max %	10 / 14
Weight	31	Weight		Including battery acc. to ISO 5053 - 87	kg	2786 2962
	32	Axle load		With load front/rear	kg	3434/576 4142/415
	33			Without load front/rear	kg	1360/1426 1435/1527
Chassis	34	Tyres		Front/rear		2 / 2
	35			Size, front		18 x 7 - 8
	36			Size, rear		16 x 6 - 8
	37	Wheelbase	Y	mm	1280	
	38	Track width		Front/rear	mm	821 / 774
	39	Ground clearance	m_1	Beneath mast with load	mm	80
	40		m_2	Center of wheelbase with load	mm	104
41	Service brake			Mech./hydr./pneum./combined		Hydraulic
42	Parking brake			Hand/foot		Hand
Drive	43	Battery		Type		Panzer
	44			Voltage/rated capacity (5h)	V/Ah	48/400; 48/440 48/480; 48/560
	45			Weight	kg	755 950
	46	Electric motors		Drive motor $S_2 - 60$ min	kW	7,5
	47			Lift motor $S_4 - 25\%$	kW	10
	48	Drive control			Type	
49	Transmission			Type		Mechanical
50	Working pressure			For attachments	MPa	14
51	Noise level			Average value at operator's ear	dB(A)	70...72

1) For other lift heights refer to MAST table.

2) Recommended fork dimensions

* Electric forklifts in accordance with BDS EN 1726-2

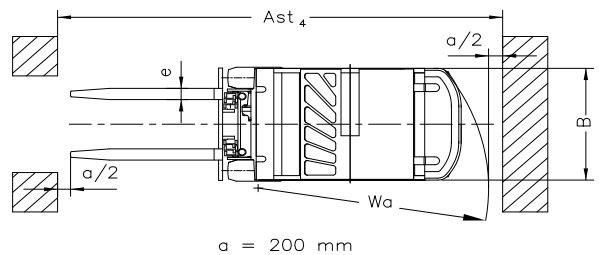
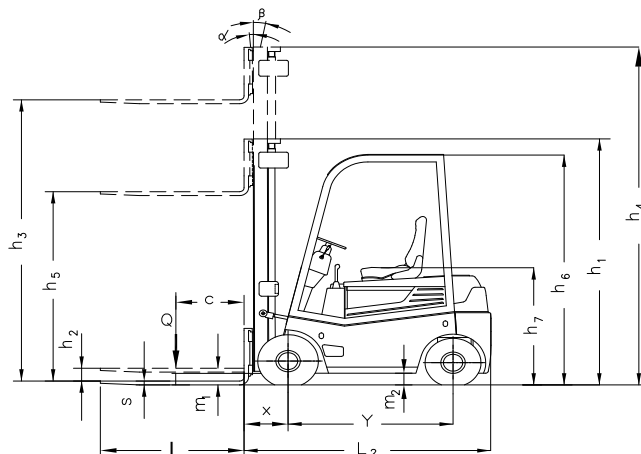

$a = 200 \text{ mm}$

MAST				
TYPE	LIFT HEIGHT h ₃	HEIGHT, MAST LOWERED h ₁	HEIGHT, MAST EXTENDED h ₄	FREE LIFT h ₂ /h ₅

SIMPLEX - 1,25; 1,6 t ELECTRIC FORKLIFT
(Two masts, Free lift)

33 S	3300	2220	3825	90
40 S	4000	2570	4525	90

DUPLEX - 1,25; 1,6 t ELECTRIC FORKLIFT
(Two masts, Extended free lift)

28 D	2800	1970	3370	1400
------	------	------	------	------

TRIPLEX - 1,25; 1,6 t ELECTRIC FORKLIFT
(Three masts, Extended free lift)

42 T	4200	1970	4770	1400
45 T	4500	2070	5070	1500
50 T	5000	2220	5520	1660
54 T	5400	2370	5970	1800
60 T	6000	2570	6570	2000